

# Assembly instruction

## Telescopic slide 755013-lock with locking mechanism



Pay attention to minimum distance between body and drawer!



Installation length as per product description plus 27 mm release lever.

When using the one-hand locking mechanism, 47 mm of space is required.



Convenient installation due to separable inner rail.

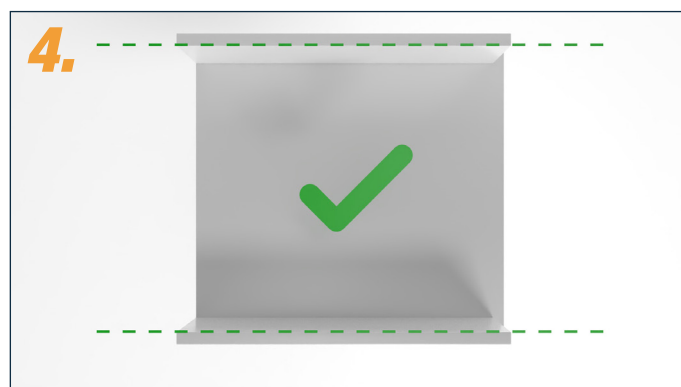

Side walls of the cabinet body must be parallel.



Side walls of the cabinet body must be flush at the front.



Outer rail must run parallel to the floor.

# Assembly instruction

## Telescopic slide 755013-lock with locking mechanism

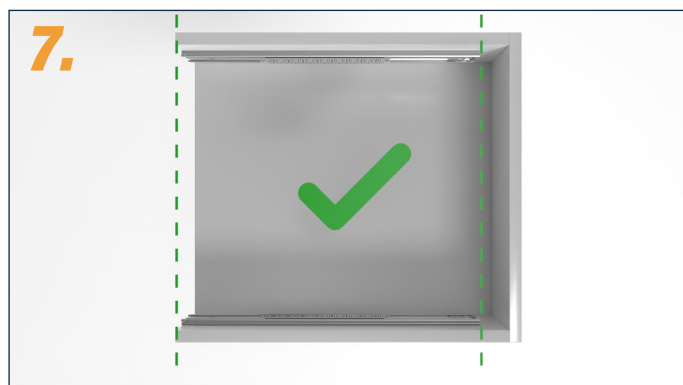

Outer rails must be flush and parallel at the front.

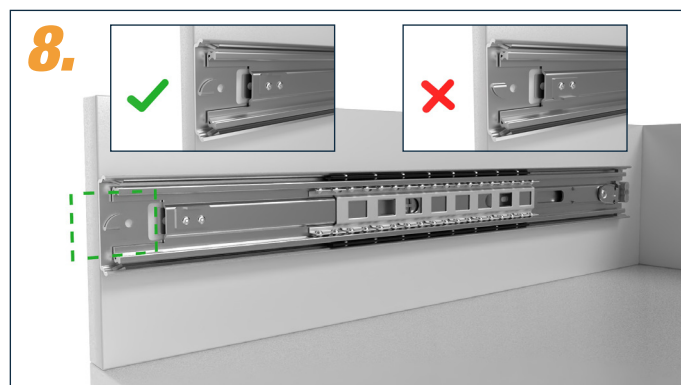

We recommend that the tab on the outer rail should point upwards.



The outer rail can be fixed in the slotted holes with screws and still be aligned. e.g. with 4 mm round-head screw (not supplied). Screws can optionally be removed after installation.



Fasten the outer rail with screws.  
For metal body e.g. with flat head screw M4x8  
with wooden body e.g. with flat head screw 4x14  
(available in our online shop).

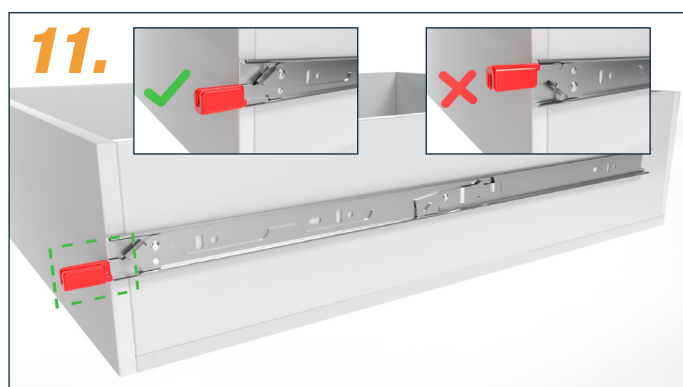

When installing the inner rail, the locking lever must point downwards.  
**ATTENTION!** The right and left inner rails must not be installed interchangeably.



The inner rail can be fixed with screws in the slotted holes e.g. with a 4 mm round-head screw (not supplied). Screws can be optionally removed again after installation.

# Assembly instruction

## Telescopic slide 755013-lock with locking mechanism



**13.**  
Fasten the inner rail with screws.  
For metal body e.g. with flat head screw M4x10,  
for wooden body e.g. with flat head screw 4x14  
(available in our online shop).

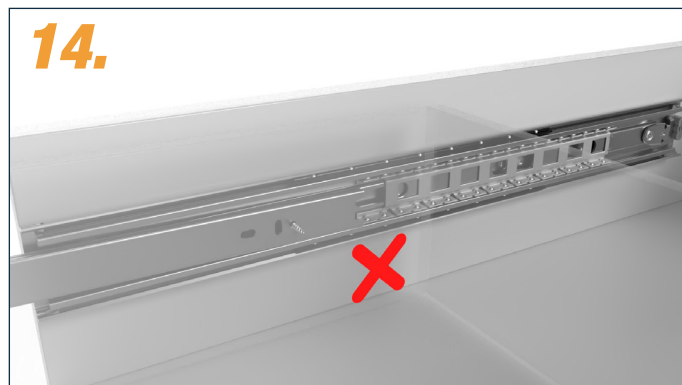

**14.**  
Incorrect handling can cause the rail to tilt. We accept no liability for any resulting damage.

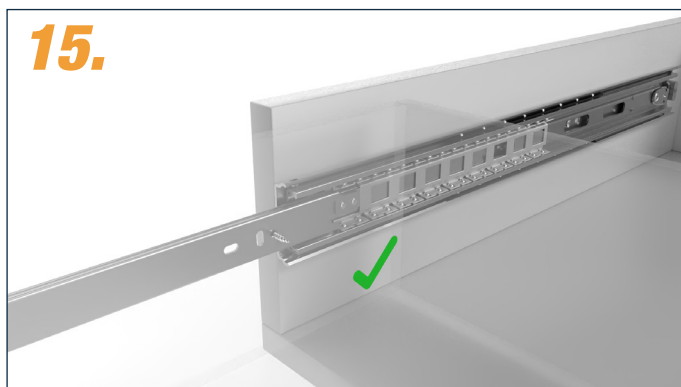

**15.**  
Before installation, the ball cage must be pushed forward.



**16.**  
Always operate the levers when closing the drawer.



**17.**  
Further information and a suitable installation video  
can be found on our website [www.multislides.eu](http://www.multislides.eu)